

## VENTILCONVETTORE SERIE VE IN CONTROSOFFITTO

Questa serie viene prodotta su richiesta. Può essere dotata da 1,2,3,4 o 5 elettroventilatori silenziosissimi, funzionanti in modo indipendente e pilotati ognuno con il prestigioso sistema a portata variabile dell'aria, in modo completamente automatico (variomatic system) oppure con il variatore di velocità regolabile in modo manuale.

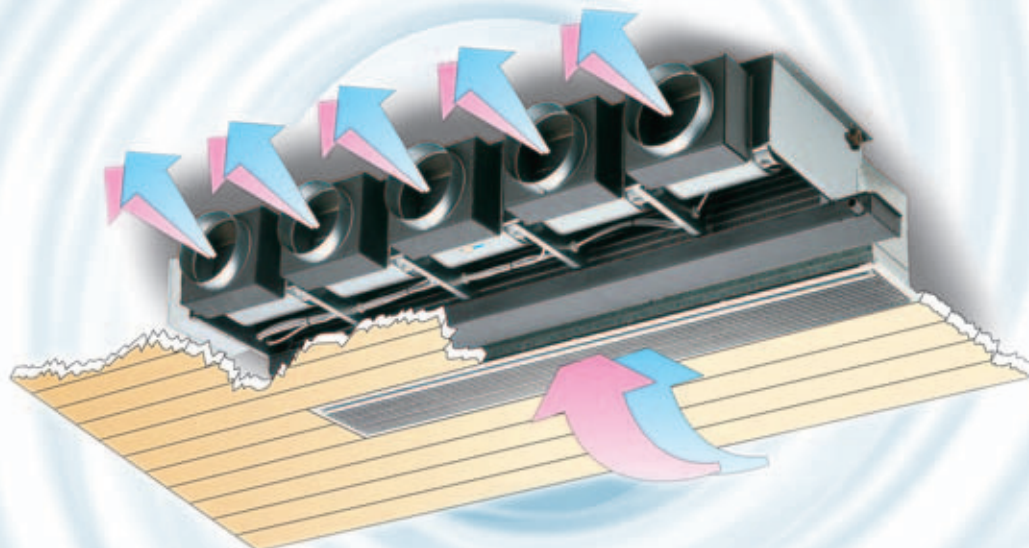

## FAN CONVECTORS VE SERIES COUNTER-CEILING

*This series is manufactured on request. It can be equipped with 1,2,3,4 or 5 noiseless electric fans, each of them working independently and driven by the powerful variable automatic airflow system (variomatic system) or by the variable-speed drive manually adjustable.*

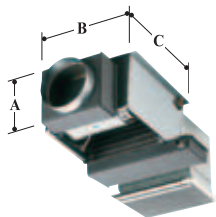

VE 1

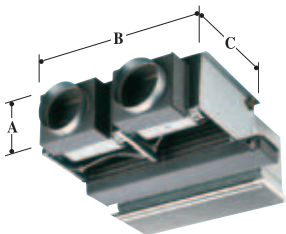

VE 2

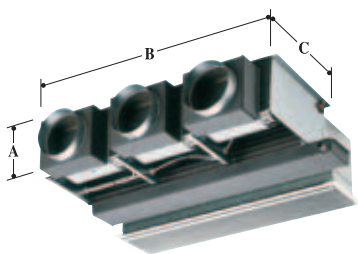

VE 3

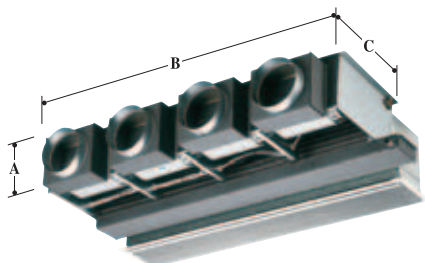

VE 4

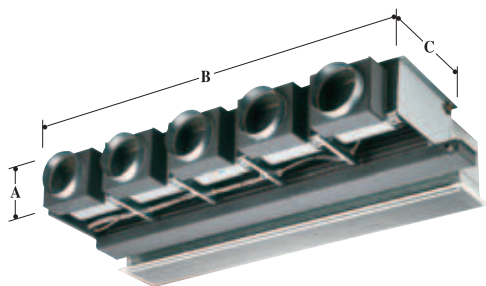

VE 5

INGOMBRI E DIMENSIONI in mm.  
OVERALL DIMENSIONS in mm.

Modelli - Models	VE1	VE2	VE3	VE4	VE5
A	220	220	220	220	270
B	400	800	1000	1350	1660
C	450	450	450	450	450

Riscaldamento ad acqua / Water heating

<b>Potenzialità termica con temperatura acqua entrante 70° C uscita 58° C</b> <b>Alla portata aria massima</b> <b>Aria ambiente 20° C 50% UR</b> <i>Thermal capacity with an inbound water temperature equal to 70° C and an outbound water temperature of 58° C</i> <i>At maximum air flow</i> <i>Room temperature 20° C and 50% UR</i>	<b>vel. Max.</b> <i>Max. speed</i>	kCal/h	5300
	<b>vel. Med.</b> <i>Med. speed</i>	kCal/h	3600
	<b>vel. Min.</b> <i>Min. speed</i>	kCal/h	1300
	<b>vel. Max.</b> <i>Max. speed</i>	kW	6.16
	<b>vel. Med.</b> <i>Med. speed</i>	kW	4.17
	<b>vel. Min.</b> <i>Min. speed</i>	kW	1.51

<b>Portata acqua</b> <i>Water flow rate</i>	l/h	500
--	-----	-----

<b>Potenzialità termica</b> <b>Con temperatura acqua entrante 50° C uscita 47° C</b> <b>Portata aria massima</b> <b>Aria ambiente 20° C 50% UR</b> <i>Thermal capacity with an inbound water temperature equal to 50° C and an outbound water temperature of 47° C</i> <i>At maximum air flow</i> <i>Room temperature 20° C and 50% UR</i>	<b>vel. Max.</b> <i>Max. speed</i>	Frig/h	3100
	<b>vel. Med.</b> <i>Med. speed</i>	Frig/h	2200
	<b>vel. Min.</b> <i>Min. speed</i>	Frig/h	800
	<b>vel. Max.</b> <i>Max. speed</i>	kW	3.60
	<b>vel. Med.</b> <i>Med. speed</i>	kW	2.56
	<b>vel. Min.</b> <i>Min. speed</i>	kW	0.93

<b>Portata acqua</b> <i>Water flow rate</i>	l/h	500
--	-----	-----

Condizionamento ad acqua / Water air conditioning

<b>Potenzialità frigorifera totale</b> <b>Con temperatura acqua entrante 7° C uscita 12° C</b> <b>Alla portata aria massima</b> <b>aria ambiente 27° C B.S. 19° C B.U.</b> <i>Total cooling capacity with an inbound water temperature equal to 7° C and an outbound water temperature of 12° C</i> <i>At maximum air flow</i> <i>Room temperature 27° C B.S. and 19° C B.U.</i>	<b>vel. Max.</b> <i>Max. speed</i>	Frig/h	2050
	<b>vel. Med.</b> <i>Med. speed</i>	Frig/h	1600
	<b>vel. Min.</b> <i>Min. speed</i>	Frig/h	750
	<b>vel. Max.</b> <i>Max. speed</i>	kW	2.38
	<b>vel. Med.</b> <i>Med. speed</i>	kW	1.86
	<b>vel. Min.</b> <i>Min. speed</i>	kW	0.87

<b>Potenzialità frigorifera sensibile</b> <i>Cooling capacity sensible</i>	<b>vel. Max.</b> <i>Max. speed</i>	Frig/h	1660
	<b>vel. Med.</b> <i>Med. speed</i>	Frig/h	1300
	<b>vel. Min.</b> <i>Min. speed</i>	Frig/h	620
	<b>vel. Max.</b> <i>Max. speed</i>	kW	1.93
	<b>vel. Med.</b> <i>Med. speed</i>	kW	1.51
	<b>vel. Min.</b> <i>Min. speed</i>	kW	0.72

<b>Portata acqua</b> <i>Water flow rate</i>	l/h	500
--	-----	-----

Caratteristiche tecniche / Technical data

<b>Portata aria - Air flow</b>	<b>vel. Max.</b> <i>Max. speed</i>	m³/h	550
		l/s	153
	<b>vel. Med.</b> <i>Med. speed</i>	m³/h	320
		l/s	90
	<b>vel. Min.</b> <i>Min. speed</i>	m³/h	100
		l/s	28

<b>Potenza massima assorbita da un ventilatore</b> <i>Maximum power absorbed by the fan</i>	W	105
--	---	-----

<b>Corrente massima assorbita da un ventilatore</b> <i>Maximum capacity absorbed by the fan</i>	A	0.5
--	---	-----

<b>Tensione di alimentazione</b> <i>Supply voltage</i>	Volt/Fasi/Hertz	230/1/50
---	-----------------	----------

<b>Livello di pressione sonora a 3 mt campo semisferico con canali e bocchette montate</b> <i>Sound pressure level taken 3 m from the unit in a hemispherical field with mounted ducts and nozzles</i>	<b>vel. Max.</b> <i>Max. speed</i>	dB(A)	39
	<b>vel. Med.</b> <i>Med. speed</i>	dB(A)	31
	<b>vel. Min.</b> <i>Min. speed</i>	dB(A)	22

<b>Numero di ranghi batteria</b> <i>Number of battery ranks</i>	Acqua - Water n.	4
--	------------------	---

<b>Diametro attacchi batteria</b> <i>Battery socket diameter</i>	Ad acqua - Water Ø	3/4
---	--------------------	-----

<b>Diametro scarico condensa</b> <i>Condensation exhaust diameter</i>	mm	22
--	----	----

<b>Peso di ogni singola bocca</b> <i>Weight of each nozzle</i>	Kg	13
---	----	----

Dati riferiti ad un singolo elettroventilatore / Reported data to a single electric fan